

Öhlins R&T Assortment

AUTOMOTIVE ROAD & TRACK

SAFETY PRECAUTIONS

Warning!

The shock absorber/front fork/steering damper is an important part of the vehicle and will affect the stability.

Warning!

After installing the Öhlins product, take a test ride at low speed to make sure your vehicle has maintained stability.

Warning!

Some of Öhlins products contain pressurized nitrogen gas (N₂). Do not open, service or modify pressurized products without proper education (approved Öhlins dealer/distributor) and proper tools.

Note!

Read and ensure you understand the information in this manual and other technical documents provided by Öhlins, before you use the product.

Note!

Öhlins Racing AB can not be held responsible for any damage to the shock absorber/front fork/steering damper, vehicle, other property or injury to persons, if the instructions for mounting, usage and maintenance are not obeyed.

Warning!

If the suspension makes an abnormal noise, or the function is irregular, or if you notice any leakage from the product, stop the vehicle immediately and return the product to an Öhlins Service Centre.

Warning!

The product warranty shall only apply if the product has been operated and maintained in accordance with recommendations in this manual. If you have any questions regarding usage, service, inspection and/or maintenance contact Öhlins.

Note!

When working with the Öhlins product, read the Vehicle Service Manual.

SAFETY SYMBOLS

In this manual, mounting instructions and other technical documents, important information concerning safety is distinguished by the following symbols:



The Safety Alert Symbol means: Warning! Your safety is involved.

Warning!

The Warning Symbol means: Failure to follow warning instructions can result in severe or fatal injury to anyone working with, inspecting or using the shock absorber, or to bystanders.

Caution!

The Caution Symbol means: Special precautions must be taken to avoid damage to the shock absorber.

Note!

The Note Symbol indicates information that is important regarding procedures.

Warning!

This product was developed and designed exclusively for a specific vehicle model and shall only be installed on the intended vehicle model in its original condition as delivered from the vehicle manufacturer.

© Öhlins Racing AB. All rights reserved.

Any reprinting or unauthorized use without the written permission of Öhlins Racing AB is prohibited.

Contents

1 - Rebound adjusters.....	3
2 - Bellows	4
3 - Bump stops.....	5
4 - Spring platform, adjustment nuts and spring seat	6
5 - Spacers	6
6 - Control wires, knob and screw.....	7
7 - Sleeve.....	8
8- Adjuster cup.....	8
9 - Hex nut	8
10 - End clevis	8
11 - End eye	8
12 - Top mounts	9
13 - Spanner	19

AUTOMOTIVE ROAD & TRACK

1 - Rebound adjusters

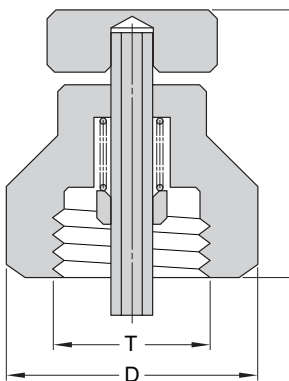
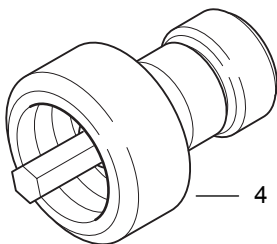
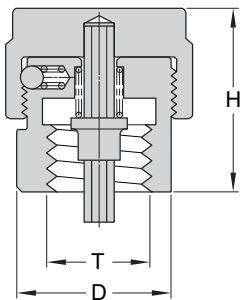
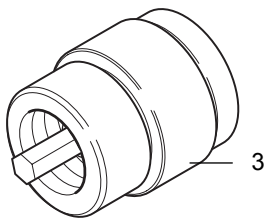
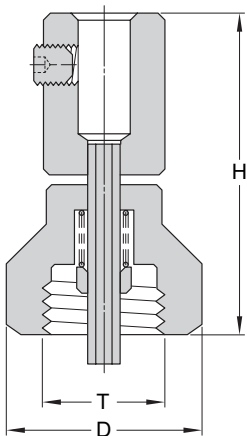
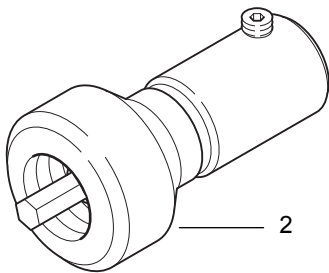
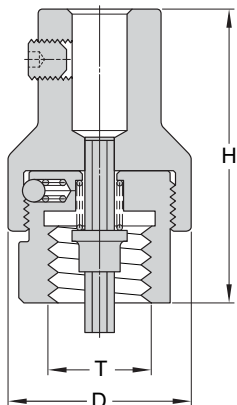
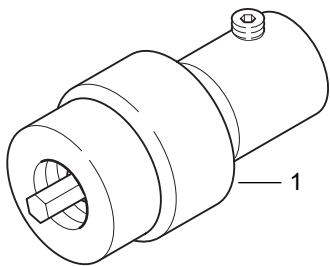

Pos	Part No	H	D	T
1-1	24631-03	29 mm	18 mm	M10 x 1.25
1-2	24631-01	35 mm	-	M12 x 1.25
1-3	24631-04	18 mm	18 mm	M10 x 1.25
1-4	24631-02	19 mm	-	M12 x 1.25

AUTOMOTIVE ROAD & TRACK

2 - Bellows

Pos	Part No	H	D
2-1	10216-01	157 mm	58 mm
2-2	10216-02	145 mm	59 mm
2-3	10216-03	240 mm	74 mm

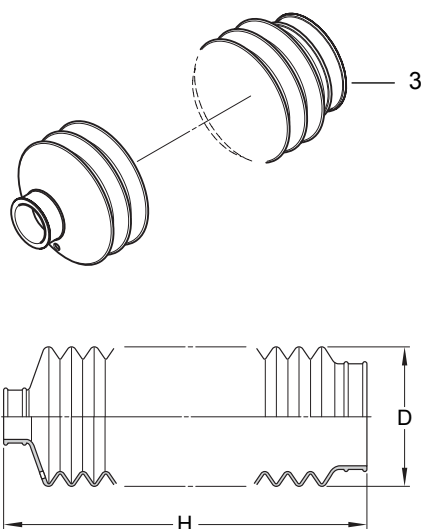
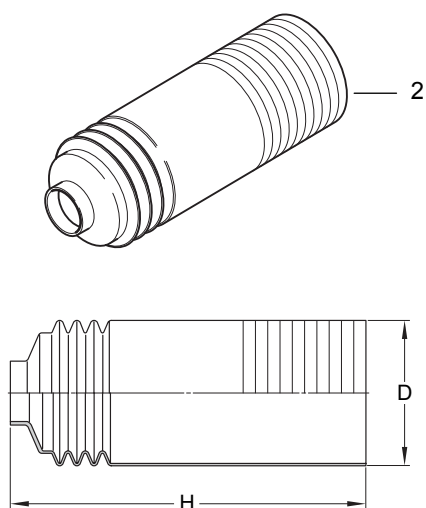
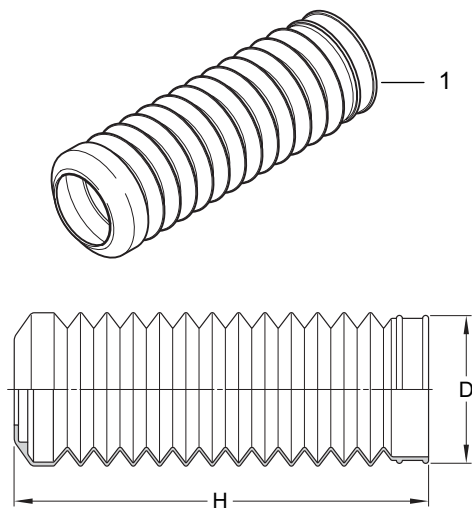

3 - Bump stops

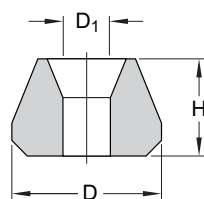
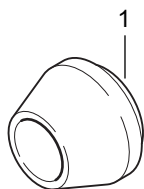

Pos	Part No	H	D	D ₁
3-1	24630-01	31 mm	37 mm	13.5 mm
	24630-02	25 mm	38 mm	
3-2	24630-03	53.5 mm	46.5 mm	13.5 mm

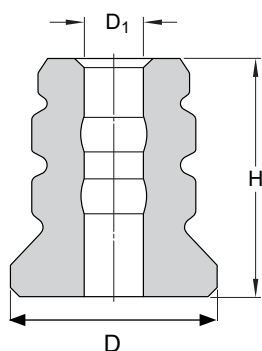
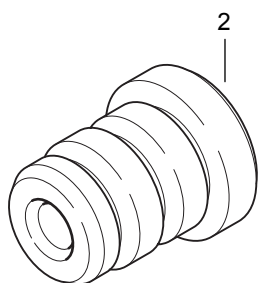

AUTOMOTIVE ROAD & TRACK

4 - Spring platform, adjustment nuts and spring seat

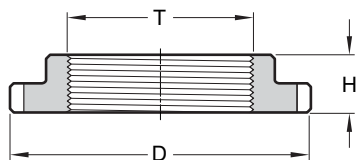
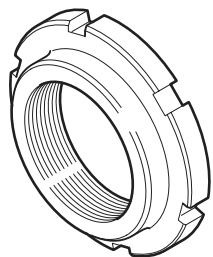

Pos	Part No	H	D	T
4-1	24635-03	16 mm	84 mm	M52 x 1.5
4-1	24635-02	16 mm	84 mm	M52 x 2.0
4-1	24635-01	16 mm	84 mm	M56 x 2.0
4-1	24635-04	16 mm	89 mm	M60 x 2.0

Adjustment nut

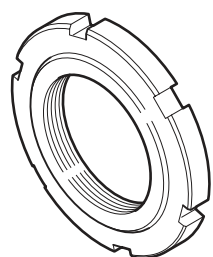

Pos	Part No	H	D	T
4-2	24636-02	9 mm	76 mm	M52 x 2.0
4-2	24636-01	9 mm	76 mm	M56 x 2.0
4-2	24636-04	9 mm	75 mm	M60 x 2.0

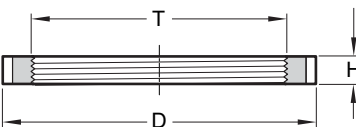
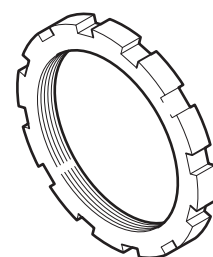

Pos	Part No	H	D	T
4-3	24636-03	6 mm	64 mm	M52 x 1.5

Spring seat

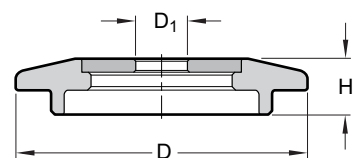
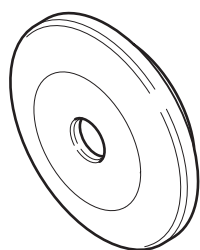

Pos	Part No	H	D	D ₁
4-4	24637-01	16 mm	84 mm	15 mm
4-4	24637-02	16 mm	84 mm	14 mm

5 - Spacer, rubber



Spacer, nylon



Pos	Part No
5-1	25601-01

Pos	Part No
5-2	25602-01

6 - Control wires, knob and screw

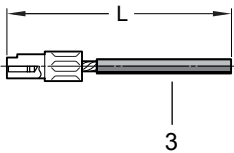
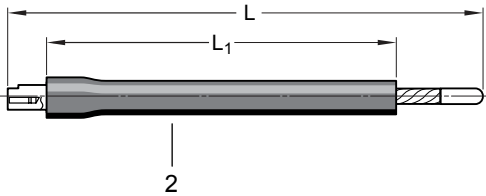
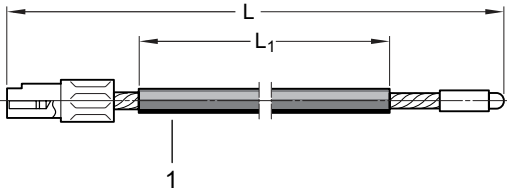

Pos	Part No	L	L ₁
6-1	24632-01	380 mm	330 mm
	24632-02	280 mm	230 mm
6-2	24632-03	136 mm	100 mm
6-3	24632-04	65 mm	-

Control knob

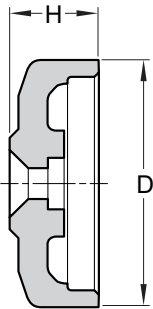
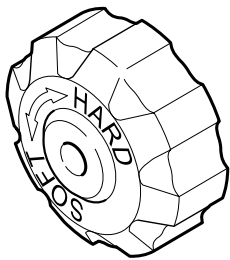

Pos	Part No	H	D
6-4	24633-01	15 mm	31 mm

Screw control knob

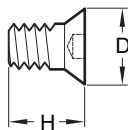

Pos	Part No	H	D
6-5	24633-02	11,5 mm	9 mm

AUTOMOTIVE ROAD & TRACK

7 - Sleeve

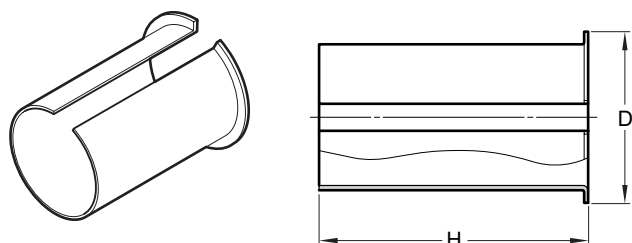

Pos	Part No	H	D
7-1	24638-01	101.6 mm	54.8 mm

8 - Adjuster cup

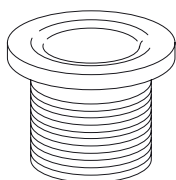

Pos	Part No	Height
8-1	25617-01	62 mm
	25617-02	90 mm
	Use together with	
	Spring platform	24635-03
	Adjustment nut	24636-03

9 - Hex nut



Pos	Part No		
9-1	25604-01	M14x1,5	Note! 6 mm high

10 - End clevis

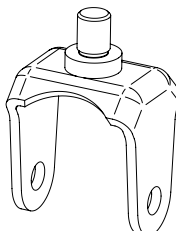

Pos	Part No
10-1	25606-01

11 - End eye

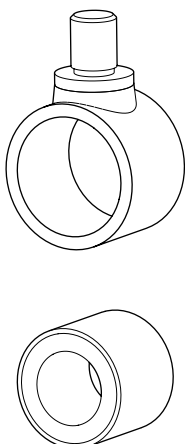

Pos	Part No	
11-1	25607-01	End eye
11-2	25608-01	Rubber bushing 16/37/37

AUTOMOTIVE ROAD & TRACK

12 - Top mounts

12-1

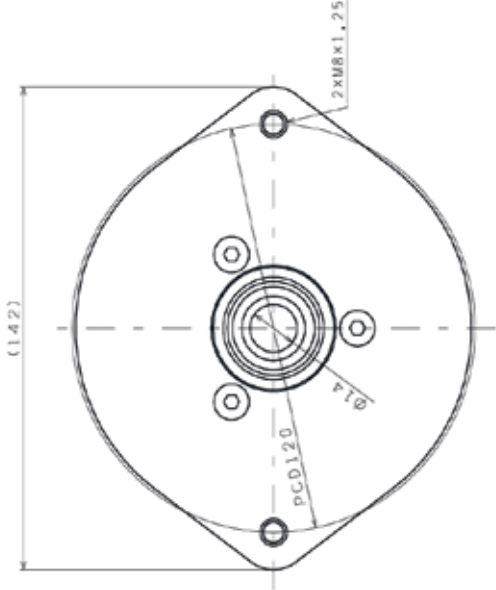

12-2

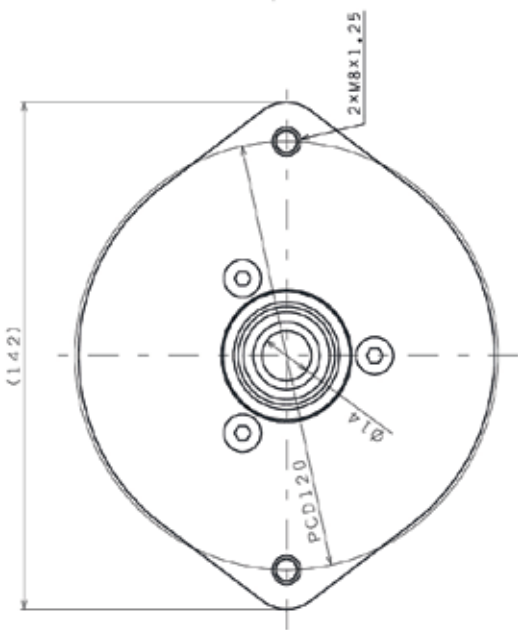

12-3

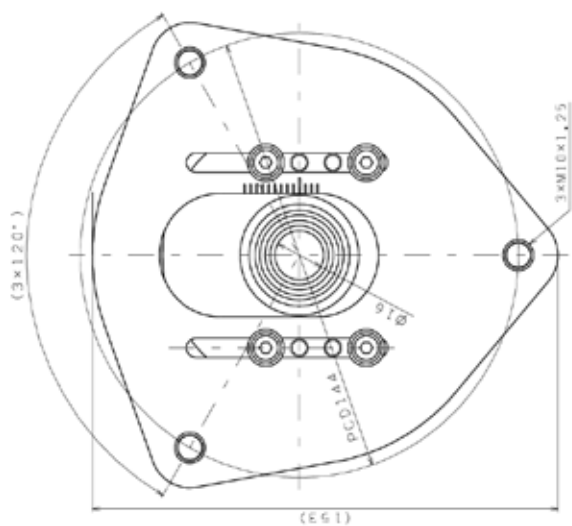

Pos	Part No	Vehicle model
12-1	25633-01	Mazda MX5 NA/NB 1989-2005, front
12-2	25633-02	Mazda MX5 NA/NB 1989-2005, rear
12-3	25633-03	Mitsubishi Lancer, EVO VII-IX, 2001-2007, front

AUTOMOTIVE ROAD & TRACK

12-4

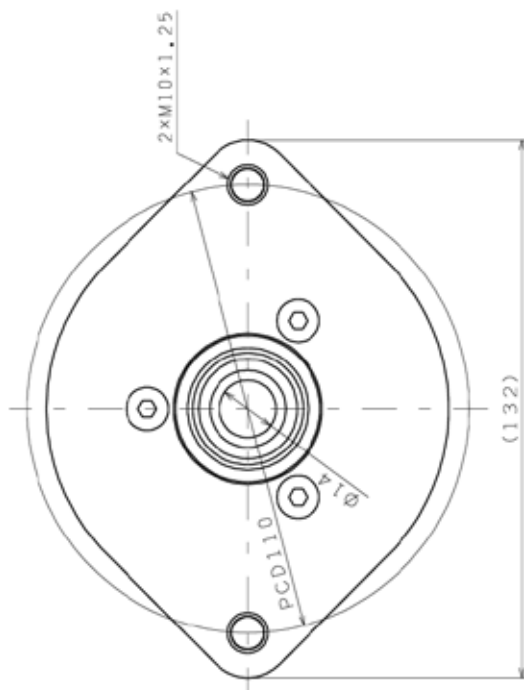

Pos Part No Vehicle model

12-4 25633-04 Mitsubishi Lancer, EVO VII-IX, 2001-2007, rear

12-5 25633-05 Mazda MX5 NC/EC 2005-, front

12-6 25633-07 Mitsubishi Lancer, EVO X CZ4A 2007-, front

12-5

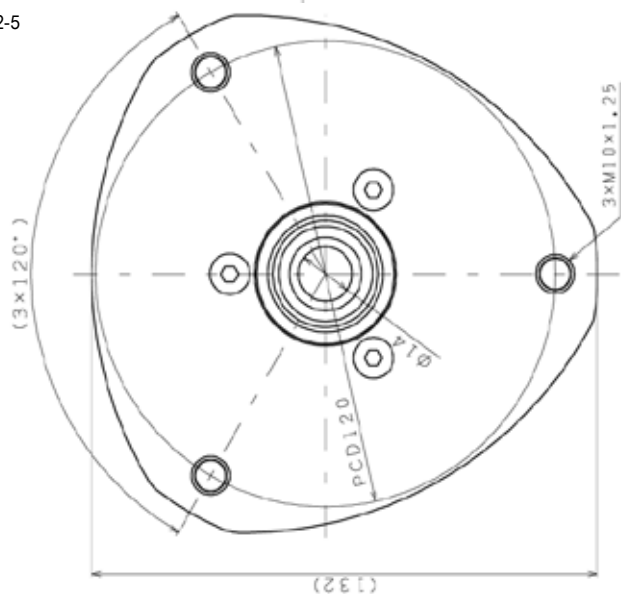

12-6

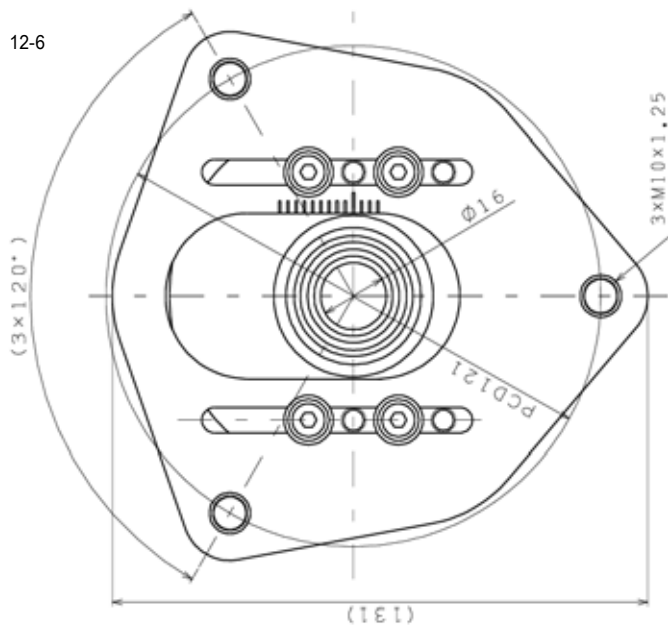

AUTOMOTIVE ROAD & TRACK

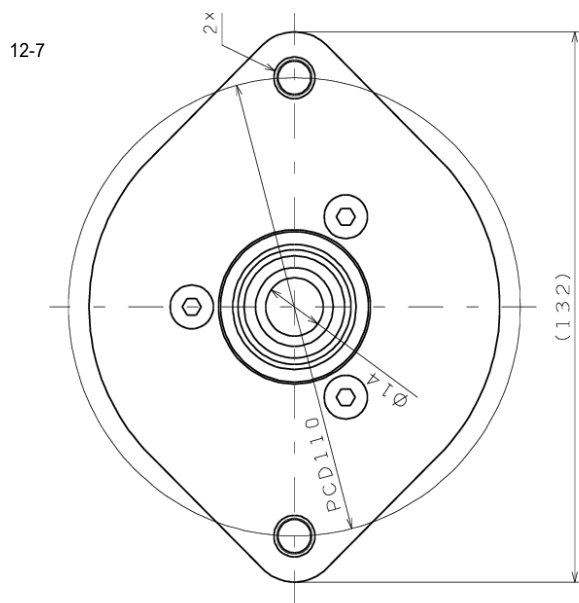

Pos	Part No	Vehicle model
-----	---------	---------------

12-7	25633-08	Mitsubishi Lancer, EVO X CZ4A 2007-, rear
------	----------	---

12-8	25633-11	Mini Cooper/Cooper S, R50/R53, front
------	----------	--------------------------------------

12-9	25633-13	Subaru Impreza STI Racing, GRB 2007-, front left
------	----------	--

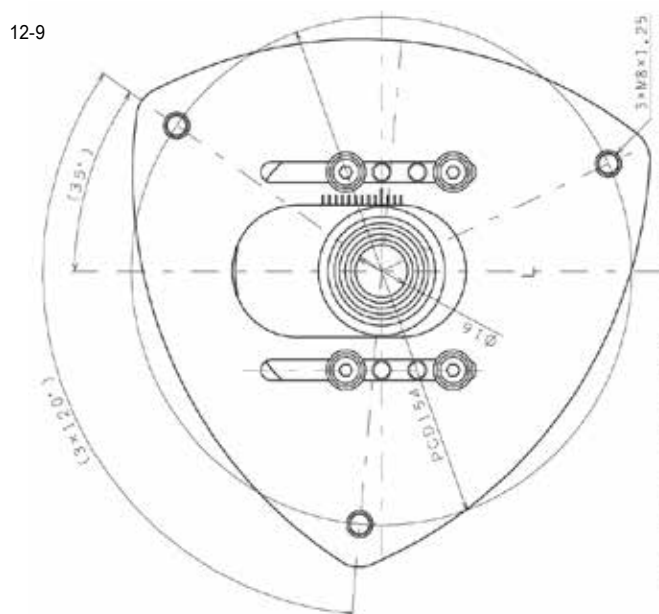
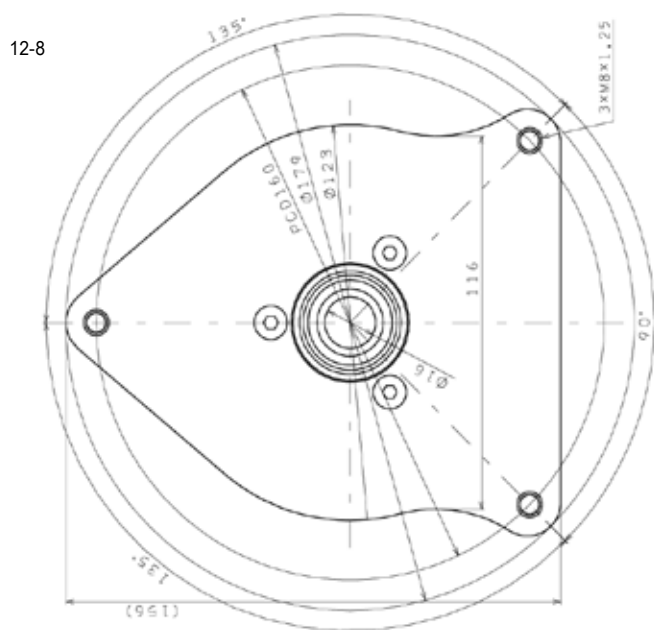

AUTOMOTIVE ROAD & TRACK

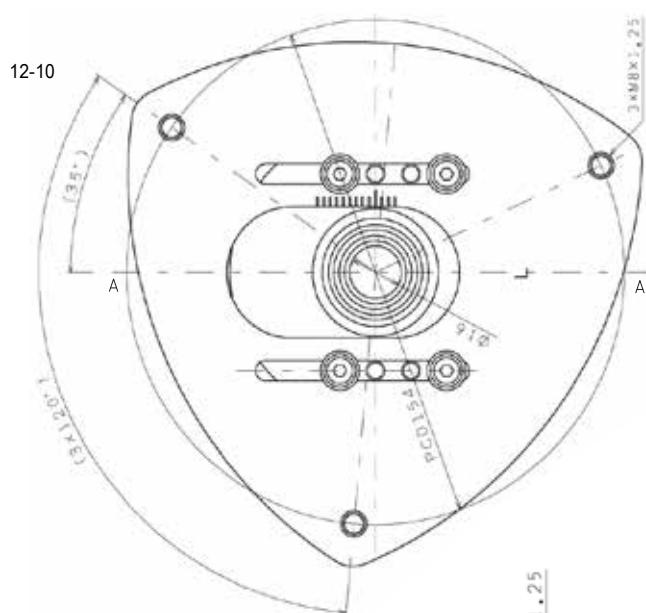

Pos	Part No	Vehicle model
12-10	25633-14	Subaru Impreza STI Racing, GRB 2007-, front right
12-11	25633-15	Subaru Impreza STI Racing, GRB 2007-, rear
12-12	25633-17	Mazda RX-8, SE3P 2003-, front

Pos	Part No	Vehicle model
12-10	25633-14	Subaru Impreza STI Racing, GRB 2007-, front right
12-11	25633-15	Subaru Impreza STI Racing, GRB 2007-, rear
12-12	25633-17	Mazda RX-8, SE3P 2003-, front

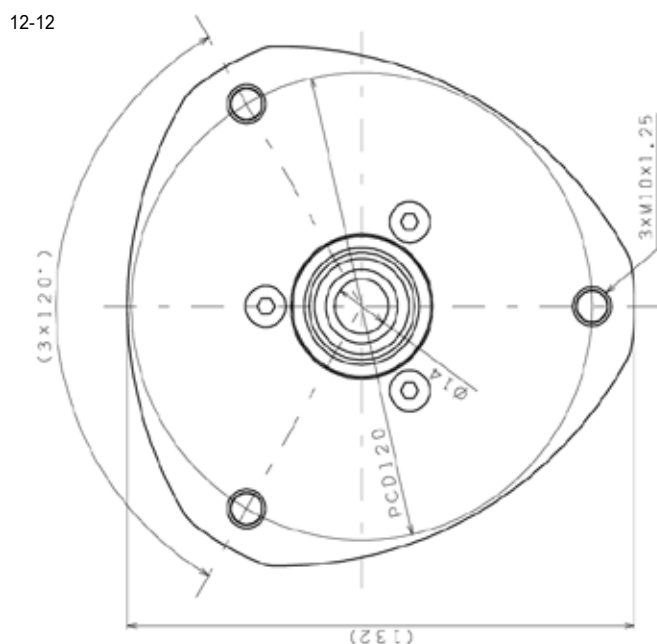
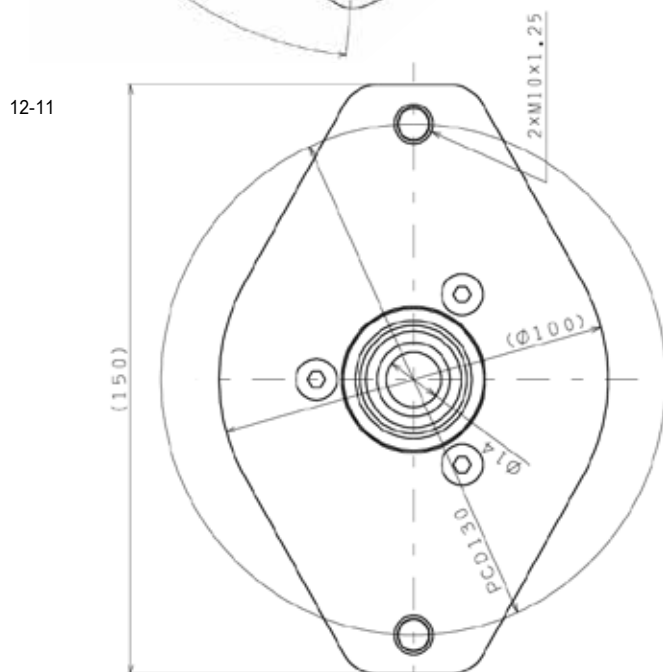

AUTOMOTIVE ROAD & TRACK

12-13

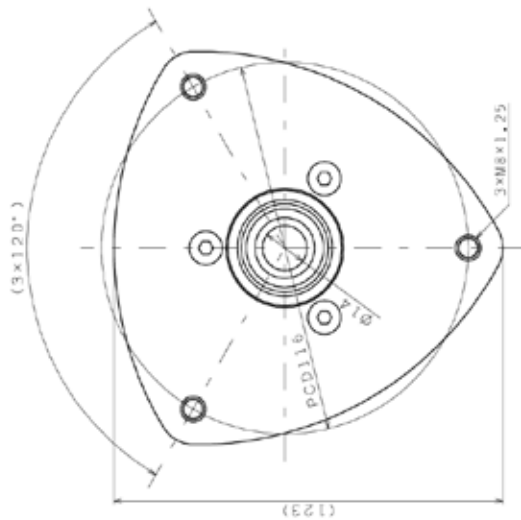

Pos Part No Vehicle model

12-13 25633-19 Nissan 350Z Z33 2002-, front

12-14 25633-20 Nissan 350Z Z33 2002-, rear

12-15 25633-23 Honda Civic Type R FD2 2007-, front left

12-14

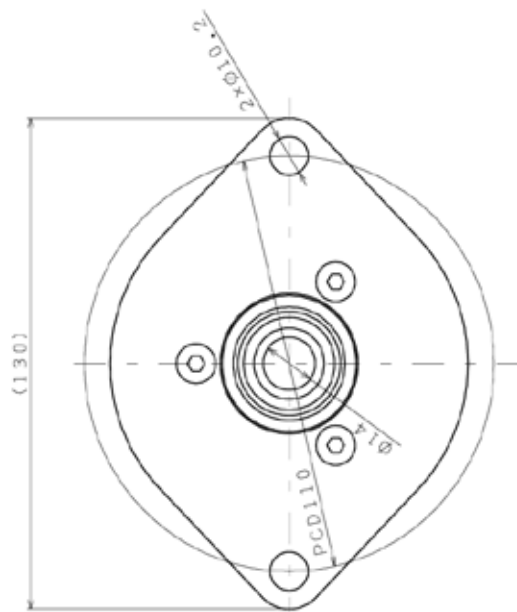

12-15

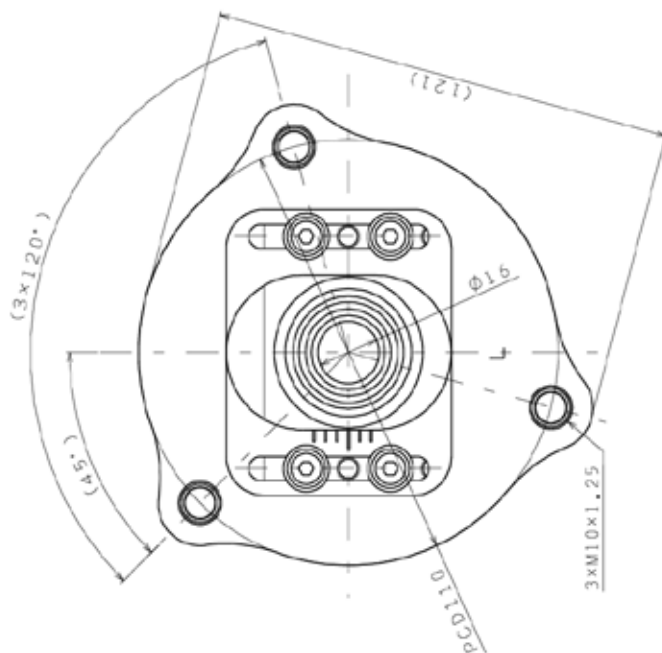

AUTOMOTIVE ROAD & TRACK

12-16

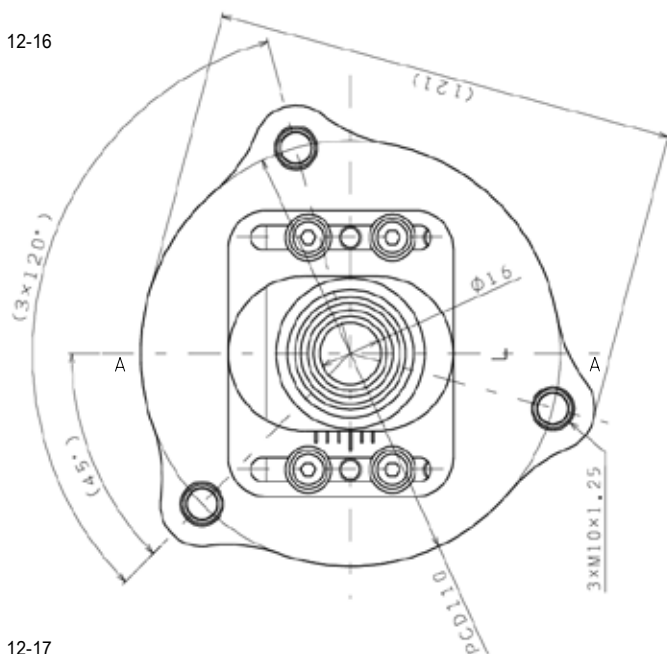

Pos Part No Vehicle model

12-16 25633-24 Honda Civic Type R FD2 2007-, front right

12-17 25633-27 Mazda RX-7 FD3S 1991-2002, front

12-18 25633-29 Mazda RX-7 FD3S 1991-2002, rear left

12-17

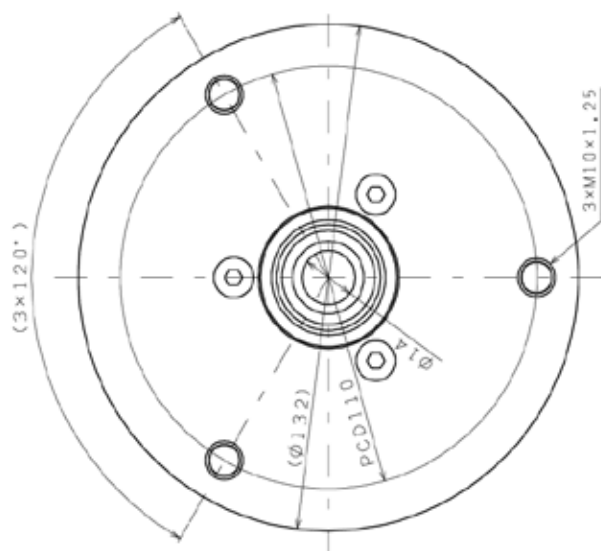

12-18

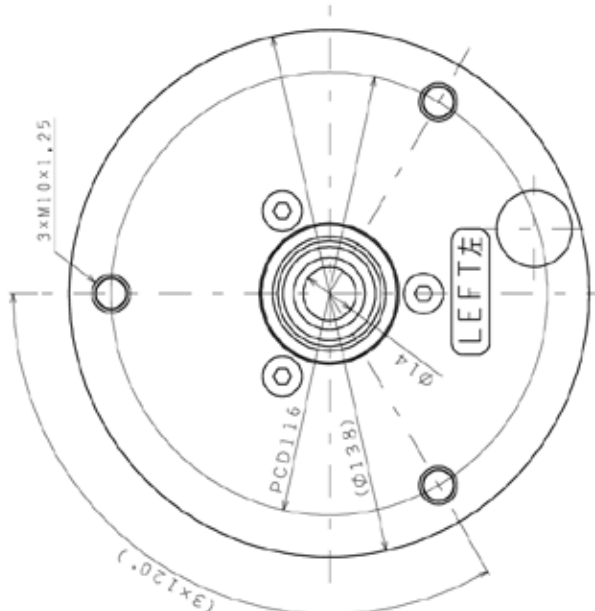

AUTOMOTIVE ROAD & TRACK

12-19

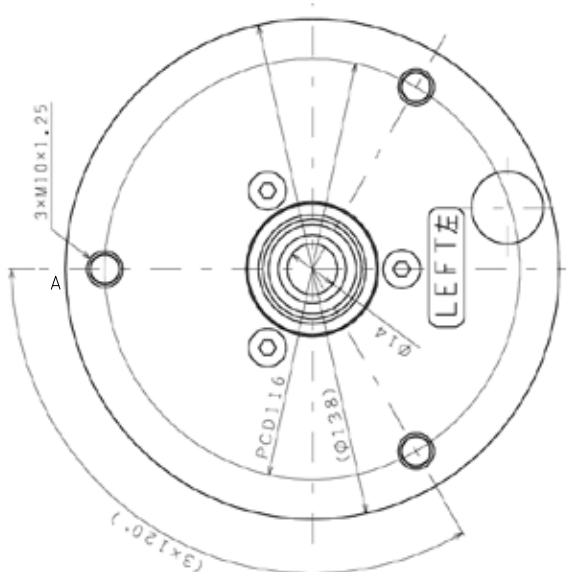

Pos Part No Vehicle model

12-19 25633-30 Mazda RX-7 FD3S 1991-2002, rear right

12-20 25633-31 Subaru Legacy BP5 2003-, front left

12-21 25633-32 Subaru Legacy BP5 2003-, front right

12-20

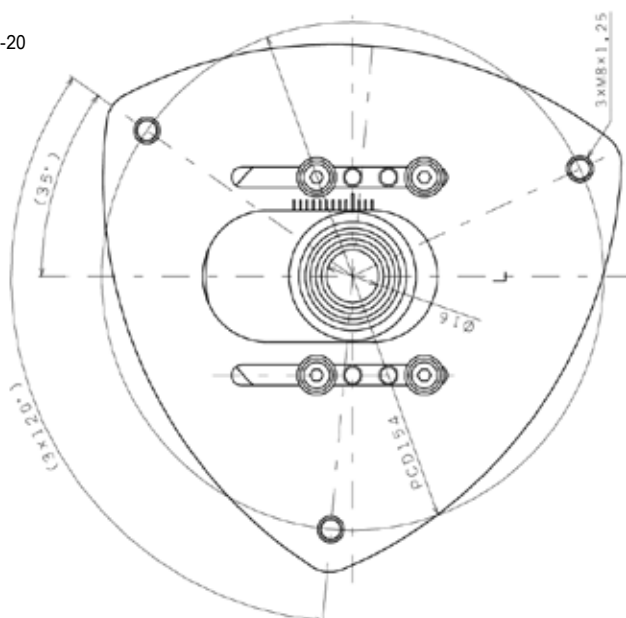

12-21

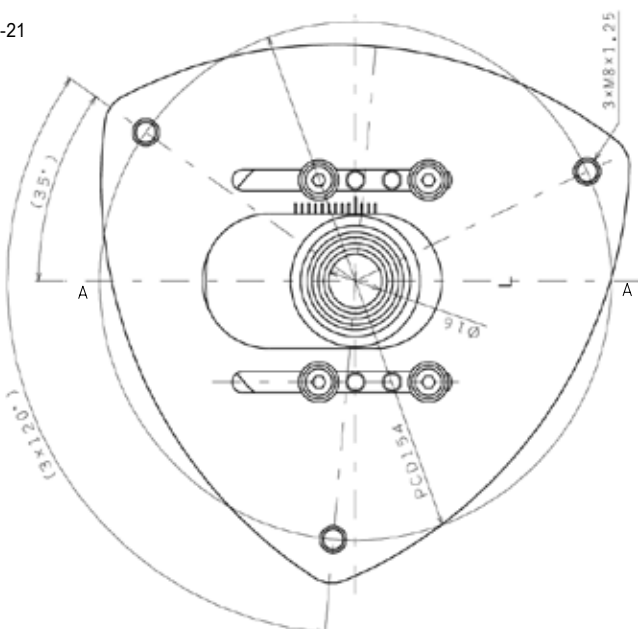

AUTOMOTIVE ROAD & TRACK

12-22

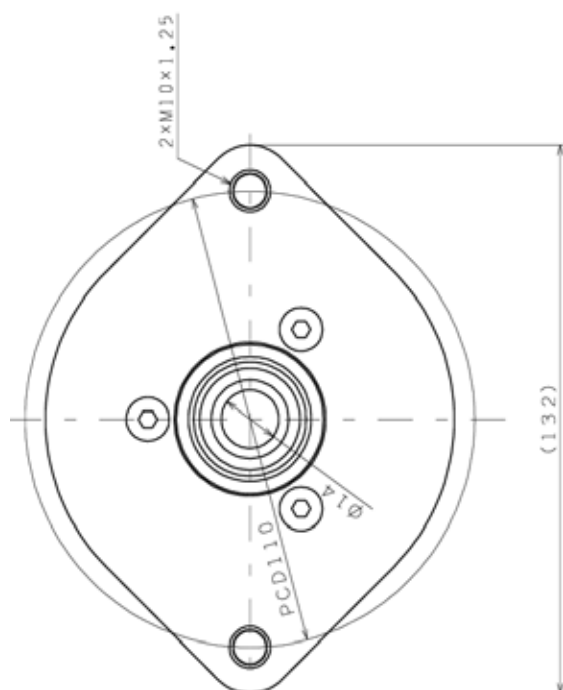

Pos Part No Vehicle model

12-22 25633-33 Subaru Legacy BP5 2003-, rear

12-23 25633-35 Honda S2000 AP1 1999-, front

12-24 25633-36 Honda S2000 AP1 1999-, rear

12-23

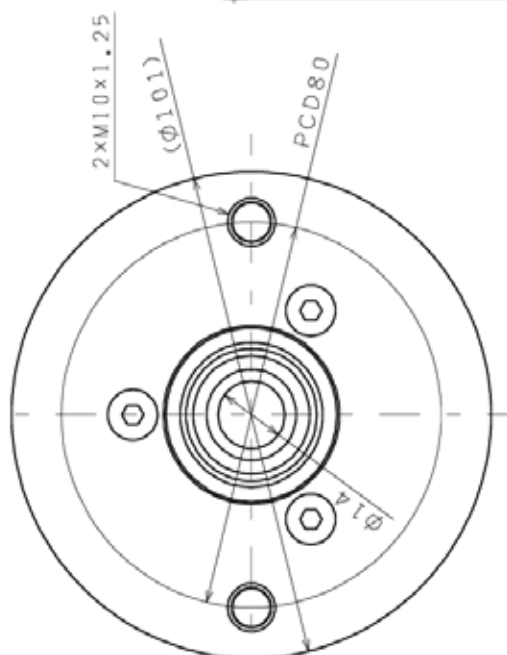

12-24

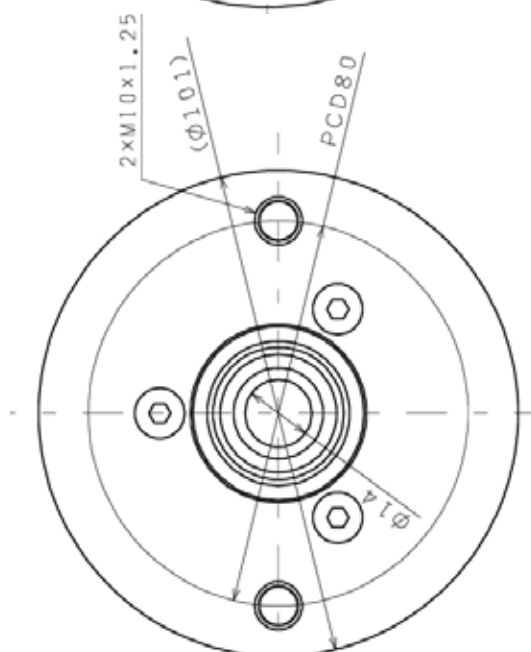

AUTOMOTIVE ROAD & TRACK

12-25

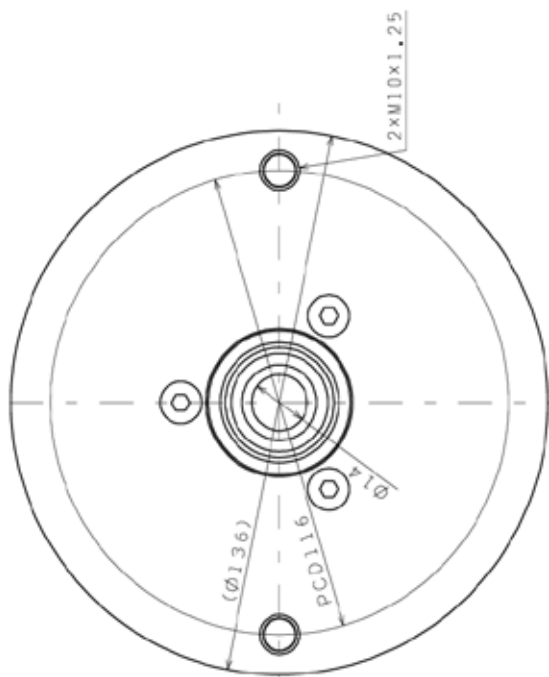

Pos Part No Vehicle model

12-25 25633-37 Nissan Skyline GT-R BNR34 99-02, front

12-26 25633-38 Nissan Skyline GT-R BNR34 99-02, rear

12-27 25633-39 Lexus IS 250/350 (GSE20/21/22), front

12-26

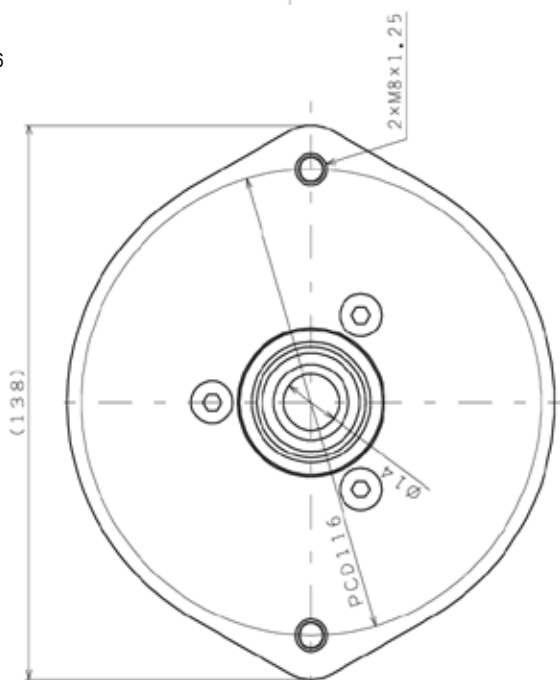

12-27

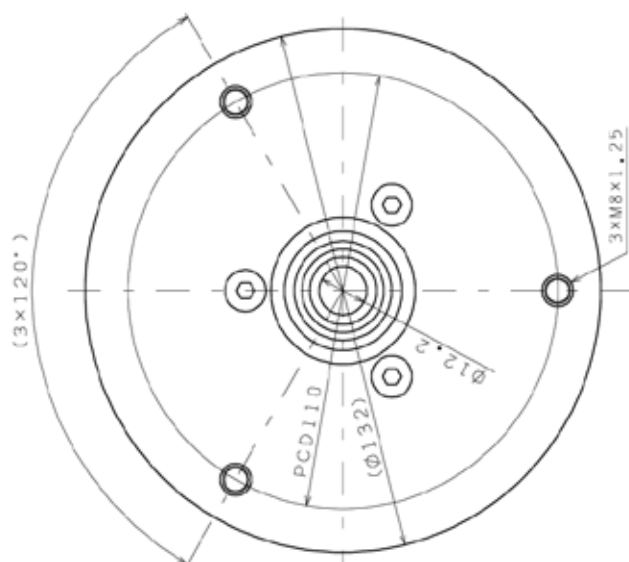

AUTOMOTIVE ROAD & TRACK

12-28

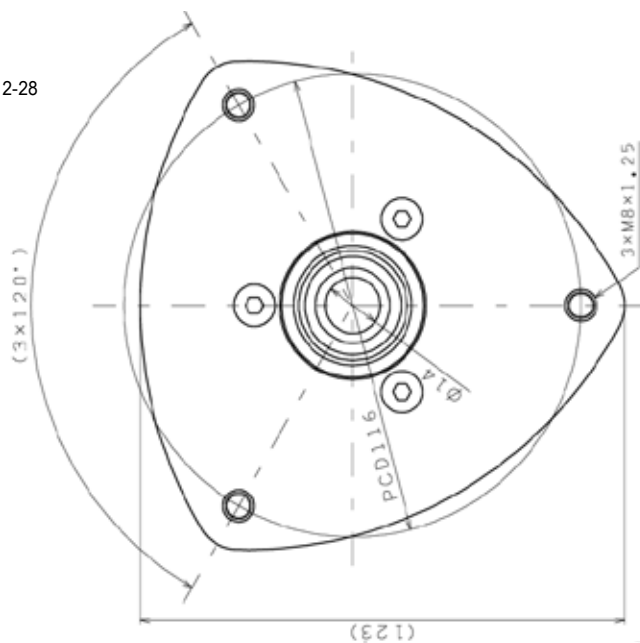

Pos Part No Vehicle model

12-28 25633-41 Nissan GT-R R35, front

12-29 25633-43 Subaru BRZ ZC6/ Toyota GT86 ZN6, front left

12-30 25633-44 Subaru BRZ ZC6/ Toyota GT86 ZN6, front right

12-29

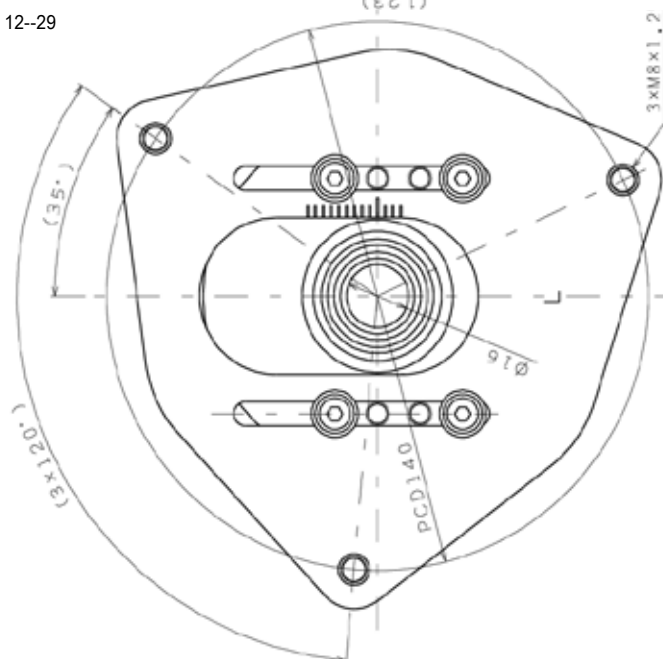

12-30

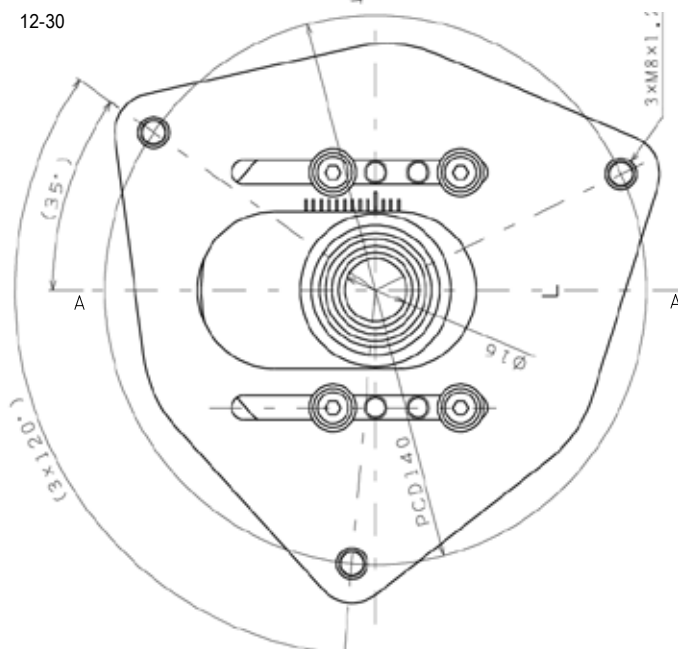

AUTOMOTIVE ROAD & TRACK

12-31

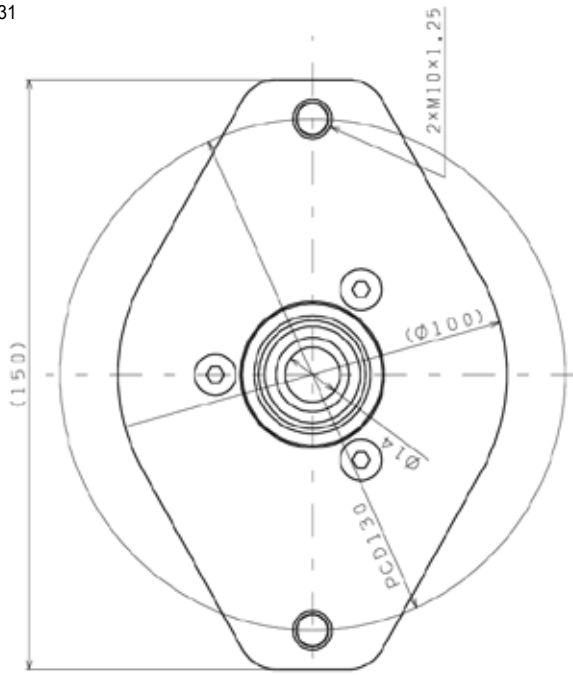

Pos	Part No	Vehicle model
12-31	25633-45	Subaru BRZ ZC6/ Toyota GT86 ZN6, rear

13 - Spanners

13-1

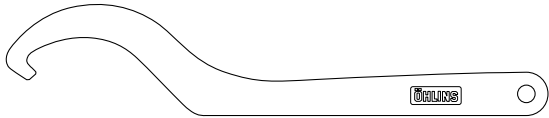

13-2

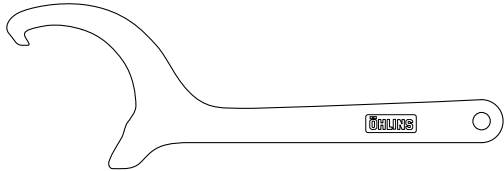

Pos	Part No	Description
13-1	24639-01	Spanner
13-2	24639-03	Spanner

Your Öhlins retailer:

Öhlins DTC
Gottlieb-Daimler-Str. 25
53520 Meuspath
Germany

Phone: +49 (0)2691 937780
Fax: +49 (0)2691 9377890
www.ohlins.eu



www.ohlins.com